



# 3M™ Adflo™ Powered Air Turbo Care and Maintenance



The 3M Adflo Powered Air Respirator System is a combined face and breathing protection device, for increased comfort and safety in welding.

To optimise the effective lifetime of your welding equipment and avoid the additional cost of replacement, regular maintenance is important.

Before Use

- Check the Battery is fully charged and fitted correctly
- Inspect the Unit for damage
- Inspect the Breathing Tube and Connections – ensure they are free from splits and holes. Replace if necessary
- Ensure Filters are correctly fitted – the particle filter must be changed if the battery operating time becomes too short. Use the electronic particle filter indicator and the graph in the user instructions to confirm battery life

**Note: the particle filter CANNOT be cleaned**

- Perform Airflow Check – fit the breathing tube to the Adflo Unit and insert Airflow Indicator Tube into the other end of the tube, switch on, ensure ball rises above the line. If the ball does not rise above the line replace the filters
- Check the low flow alarm is functioning. Cover the breathing tube opening so that no air can escape. Wait for the alarm to sound.

After Use

- The outside of the Adflo Unit can be wiped clean if necessary
- Disinfect with 3M™ 105 Wipes
- Charge Battery
- If you suspect that the inside of the Breathing Tube is dirty, it must be changed
- Store in a dry, clean area / locker away from direct sunlight, high temperatures and solvents  
DO NOT rinse or immerse in water  
DO NOT clean with solvents

Monthly

- Carry out all the 'Before Use' inspections and create record of this monthly check for the Turbo Unit

When Changing the Filter

- If necessary, clean or change the Spark Arrestor (metal mesh) on the inside of the filter cover

Ordering Consumables, Repair Parts and Accessories

To request a quote or place an order for these items, please contact your 3M Approved Distributor.

Further Information and Advice

If you require additional guidance on the Care and Maintenance of your 3M Welding Equipment, please contact the Helpline or your local 3M representative.

**3M Health & Safety Helpline**  
Monday - Friday 9 to 5  
**0870 60 800 60 UK**  
**1 800 320 500 IRELAND**

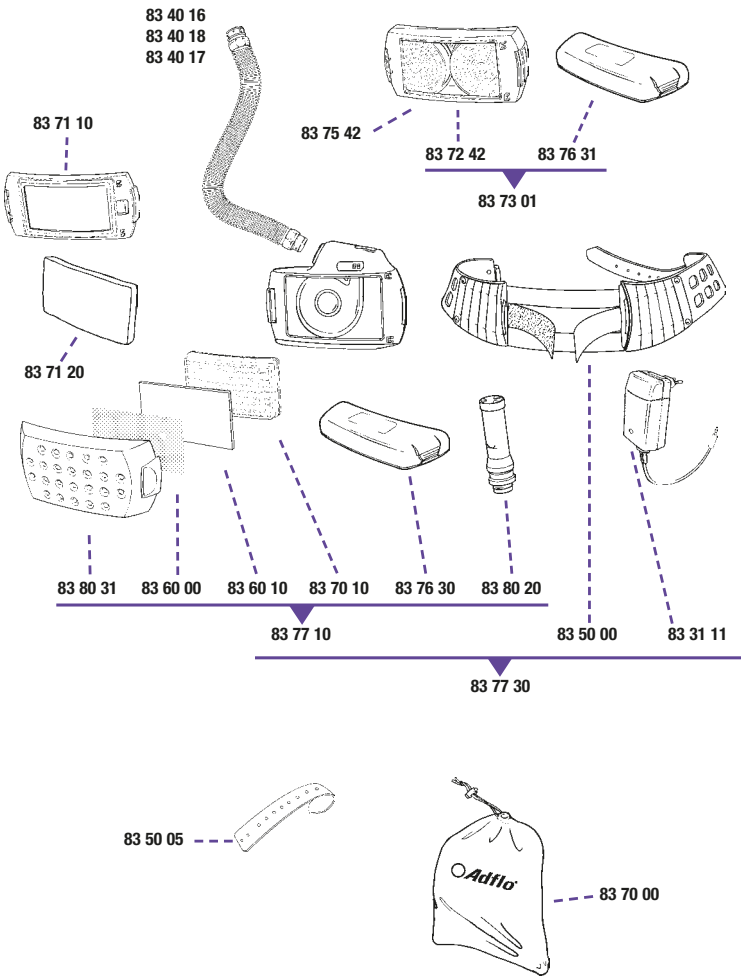

3M™ Adflo™ Respirator System

	3M Part No
Adflo unit with breathing tube, air flow indicator, prefilter, spark arrestor, particle filter and Li Ion standard battery	83 77 10
Adflo unit with breathing tube, air flow indicator, belt, spark arrestor, prefilter, particle filter, Li Ion standard battery and Lio Ion battery charger	83 77 30
Li Ion battery charger	83 31 11
Adflo unit with breathing tube, air flow indicator, prefilter, spark arrestor, particle filter, Li Ion heavy duty battery and Lio Ion battery charger	83 77 31
Breathing tube (length adjusting QRS)	83 40 16
Breathing tube cover	83 40 18
Breathing tube (rubber QRS)	83 40 17
Belt	83 50 00
Front part, belt	83 50 05
Spark arrestor	83 60 00
Prefilter (pk of 5)	83 60 10
Storage bag	83 70 00
Particle filter P SL	83 70 10
Odour filter holder and pad	83 71 10
Replacement odour filter pad	83 71 20
Gas filter A1B1E1	83 72 42
Gas filter kit, A1B1E1 filter and heavy-duty battery	83 73 01
Gas filter A2	83 75 42
Li Ion battery (standard)	83 76 30
Li Ion battery heavy-duty	83 76 31
Air flow indicator	83 80 20
Filter cover	83 80 31

@3M\_UK\_Safety

**3M Personal Safety Division**  
**3M United Kingdom plc**  
3M Centre  
Cain Road, Bracknell  
Berkshire RG12 8HT  
Tel: 0870 60 800 60  
www.3M.co.uk/Safety

**3M Ireland Limited**  
The Iveagh Building  
The Park  
Carrickmines  
Dublin 18  
Tel: 1 800 320 500

03M97586  
3M and Adflo are trademarks of 3M Company  
Please recycle. Printed in UK.  
© 3M 2015. All rights reserved.

REPLACE ALL DAMAGED PARTS IMMEDIATELY TO ENSURE  
CORRECT LEVELS OF PROTECTION

For more information on all our products, call 3M Personal Safety Division on 0870 60 800 60 (UK) and 1800 320 500 (Ireland) or visit [www.3M.co.uk/safety](http://www.3M.co.uk/safety)



Distributed by Industrial Scientific Supplies, a division of Camlab Ltd

Camlab Ltd, Norman Way Industrial Estate, Over, Cambridge, CB24 5WE  
Telephone: +44 (0)1954 233145  
Email: [sales@camlab.co.uk](mailto:sales@camlab.co.uk)  
[www.industrialscientific.co.uk](http://www.industrialscientific.co.uk)

